

POWERNAIL® CO.

1300 Rose Road, Lake Zurich, IL 60047

Phone: 1-800-323-1653

Website: www.powernail.com

Operation and Maintenance Manual

MODEL 45R TONGUE AND GROOVE NAILER **Ratcheting Nailer**



WARNING

Read this manual before you use this Nailer. Follow all safety warnings and instructions. If you are uncertain about the operation of the Nailer, call us directly a 1-800-323-1653 for assistance or contact the closest Powernail dealer for help. Please retain this information for future reference.

MODEL 45R PARTS LIST

ITEM #	PART NO.	DESCRIPTION	QTY REQ'D	KEY	Assembly or Kit
1	08-45-00-010	SPRING CLIP	1	S/K	TU
2	08-45-00-020	FEEDER CHANNEL	1	S/K	
5	08-45-00-050	ROLLER PIN ASSEMBLY	1	S/K	
13	08-45-00-130	FOOT SCREW	4	S/K	
13N	08-45-00-13N	LOCKNUT	4	S/K	
14	08-45-00-140	GATE	1	S	
15	08-45-00-150	FOOT	1	S	
16 & 19	08-45-00-160	SCREW & WASHER SET FOR SPRING CONT. (2 EA)	1	S/K	
17	08-45-00-170	SPRING CONTAINER	1	S/K	
18	08-45-00-180	FEEDER SPRING	1	S/K	TU
23	08-45-00-230	DOWEL PIN	2	S	
25	08-45-00-250	HANDLE ASSEMBLY	1	S	
29	08-45-00-290	ADAPTER PLATE PIN ASSEMBLY	1	S	
37R	07-45-00-704	RATCHET PLUNGER	1	S/K	
38	08-45-00-380	DRIVING BLADE	1	S/K	TU
41	08-45-00-410	PLUNGER SPRING PIN	1	S/K	
45	08-45-00-450	PLUNGER SPRING	1	S/K	TU
58	08-45-00-580	BLADE RETAINER	1	S/K	TU
59R	08-45R-00-59	RATCHET ASSEMBLY	1		
60	08-45-00-710	RATCHET ACCESS PLATE	1		
61	08-45-00-711	RATCHET ACCESS PLATE SCREW	2		
400	06-99-400	TOE STAND	1		
70	06-99-720	#825 NO-MAR PAD (STICK-ON) .015 THICK	1	S	

KEY: S=Sold Separately, TU=Sold as part of a Tune Up Kit, OV=Sold in an Overhaul Kit

MODEL 45R ACCESSORIES

ITEM #	PART NO.	DESCRIPTION	QTY. REQ'D
# 8-25	06-99-010	#825 ADAPTER PLATE ASSEMBLY FOR 3/4" T&G	1
72	08-45-TU-KIT	MODEL 45 TUNE-UP KIT	1

MODEL 45R EXPLODED VIEW

- 1. SPRING CLIP
- 2. FEEDER CHANNEL
- 5. ROLLER PIN ASSEMBLY
- 13. FOOT SCREW
- 13N. LOCKNUT

- 14. GATE
- 15. FOOT
- 16. SPRING CONTAINER SCREW
- 17. SPRING CONTAINER
- 18. FEEDER SPRING
- 19. SPRING CONTAINER LOCK WASHER
- 23. DOWEL PIN
- 25. HANDLE ASSEMBLY
- 29. ADAPTER PLATE PIN ASSEMBLY
- 37R. RATCHET PLUNGER
- 38. DRIVING BLADE
- 41. PLUNGER SPRING PIN
- 45. PLUNGER SPRING
- 58. BLADE RETAINER
- 59R. RATCHET ASSEMBLY
- 60. RATCHET ACCESS PLATE
- 61. RATCHET ACCESS PLATE SCREW

70. #825 NO MAR PAD (STICK-ON) .015 Thick

72. MODEL 45R TUNE UP KIT

400. TOE STAND

825-34. #825 ADAPTER PLATE ASSEMBLY FOR 3/4" T&G

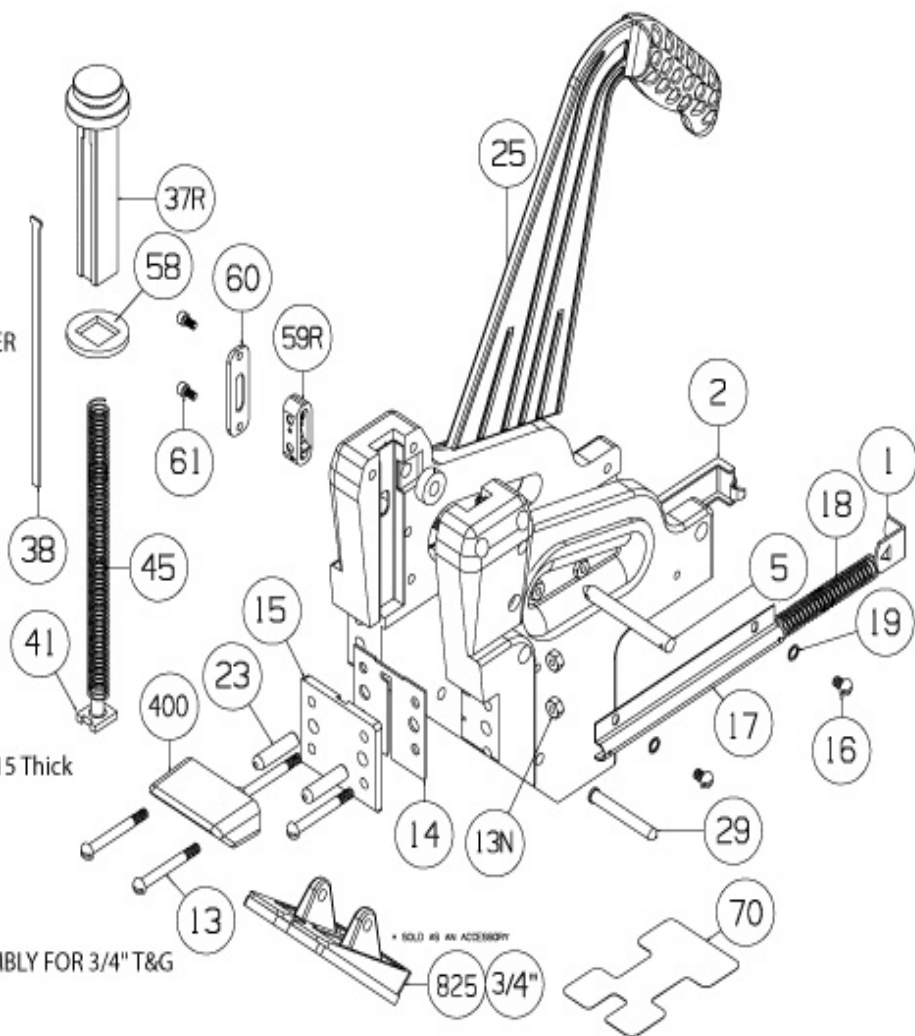

POWERCLEAT® NAIL LENGTH CHART

This chart will assist you in determining the proper length of Powercleat nails to use for various thicknesses of flooring when sub-flooring member varies as to species and thickness. Vertical penetration of the Powercleat nails under the hardwood floor is shown for each application. This is only a guide. Results should be tested in the field before proceeding.

2" Powercleats® 16 Gage

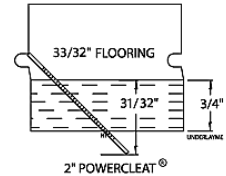
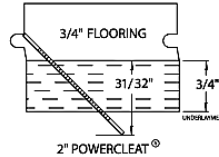
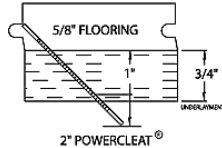
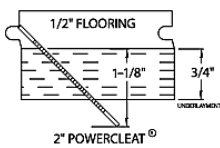

1-3/4" Powercleats® 16 Gage

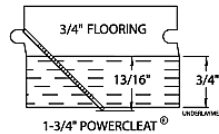
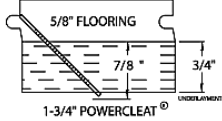
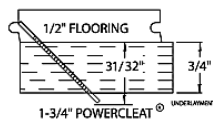

1-1/2" Powercleats® 16 Gage

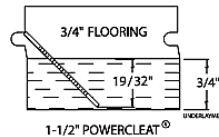
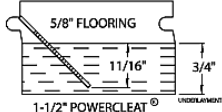
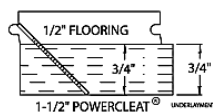

MODEL 45R & 101R RATCHET REPAIR INSTRUCTIONS

- With a 5/32 allen wrench, unscrew the two #10-32 socket head cap screws from the access plate.
- Remove access plate by turning nailer over.
- Remove ratchet insert assembly.
- Install new ratchet insert assembly as shown below.
- Replace access plate. Important: Make sure access plate is replaced as shown, with indent facing in towards ratchet.
- Fasten access plate back to body using a 5/32 allen wrench and the two socket head cap screws.

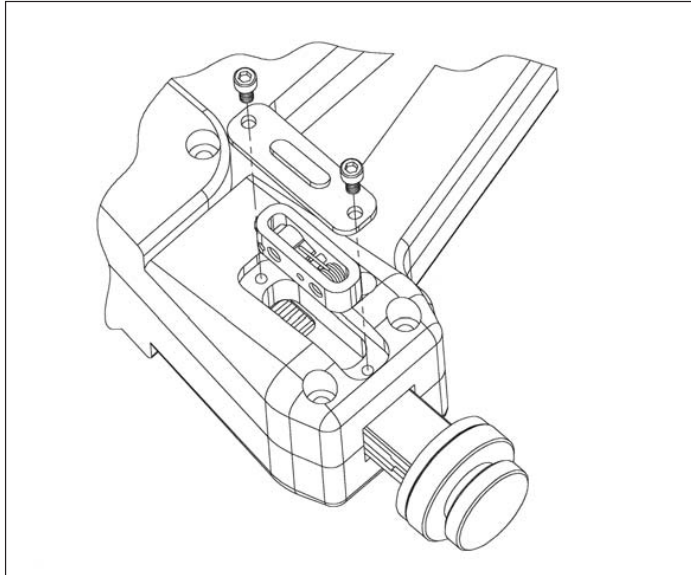

Adaptor Plates For Different Flooring Thicknesses

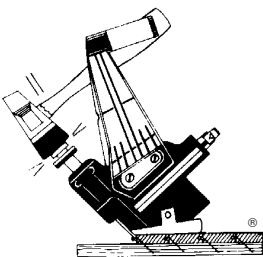

Model 45R flooring nailer fitted with 8-26 adaptor plate, to nail standard 1/2" T&G flooring.

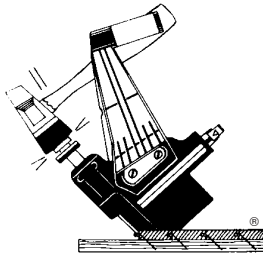

Model 45R flooring nailer without adaptor plates will nail standard 3/32" T&G flooring.

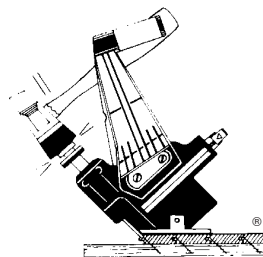

Model 45R flooring nailer fitted with 8-25 adaptor plate, to nail standard 25/32" T&G flooring.

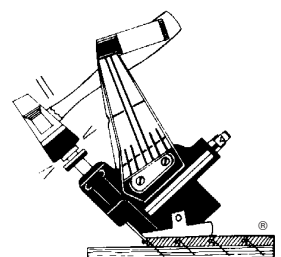

Model 45R flooring nailer fitted with 5/8" adaptor plate, to nail standard 5/8" T&G flooring.

